

Road Banner construction and fixing to poles

Technical Specifications

Reviewed May 2020

Banner construction dimensions

All banners must meet the following dimensions to be erected. Banners that do not comply with the engineering specifications will not be erected and fees will not be refunded.

Banner Location	Mounting ring spacing (m)		Banner dimensions (m)	
	Horizontal	Vertical	Span	Width
Unley Rd – North	19.4	1.3	12.0	1.25
Unley Rd– South	22.8	1.3	12.0	1.25
King William Rd - North	12.2	1.3	10.0	1.25
King William Rd - South	10.6	1.3	8.0	1.25
Goodwood Rd - North	26.9	1.3	12.0	1.25
Goodwood Rd - South	21.3	1.3	12.0	1.25

Banner construction details

Materials

Fabric: Shall be coated textile designated as Heavy Duty in accordance with AS 2930 Textiles-Coated fabrics for tarpaulins. (e.g. TOUGHSTUFF XTRA REINFORCED VINYL)

Eyelet: 15mm brass or stainless steel. It can be painted to match banner colour.

Joining: Fabric shall be jointed using plastic welding.

Assembly

All edges vertical and horizontal shall be lapped by 50mm and jointed by plastic welding. 15mm eyelets shall be fixed at no greater than 500mm spacings along banner edge. The spacing between the banner edge and the centre of eyelet hole edge shall be 25mm.

Wind holes

- The end of cutting shall be finished with 5mm diameter hole.
- Sharp ended holes or punctures are not allowed.

Wind hole specifications

Unley Road and Goodwood Road locations	Two rows U-shaped 275mm x 350mm at 1200mm spacing.
King William Road locations	Two rows U-shaped 275mm x 350mm at 1200mm spacing.

Fixing banner to poles

The City of Unley affixes the banner to wires strung between two banner poles using the following materials and methods. This detail is provided to banner supplier as information.

Steel rope fixing to the poles

Materials

2 x length	10mm diameter steel core high strength galvanised wire rope 6 x 36 - Grade 1770 WRC
6 x	10/12mm double throat wire rope grips
2 x	3.2t bow shackles nut and bolt style with split pin
2 x	24mm Grade P jaw and jaw rigging screw WLL 4.0t
2 x	10mm thimbles eyes
2 x	11mm aluminium ferrules

Fixing to poles

One end	Shackle, Jaw and Jaw rigging screw, aluminium ferrule, stainless steel tie-wire
Opposite end	Shackle, 10mm thimble eye, three double throat wire rope grips.
All shackles and turnbuckles shall be secured against unscrewing	
All ends of ropes shall be neatly tackled.	

Banner fixing to steel rope and poles

- Please refer to diagrams on following pages for each site for banner location
- Top of banner: Stainless steel 6mm LONG DEE-shackles through banner eyelet and over steel rope.
- Bottom of banner: Plastic cable ties shall be used through banner eyelet and over steel rope.
- The banner shall be stretched and located in position at each corner by two grips fixed to steel rope at top of banner only

Sagging

The upper steel rope shall not sag more than the lower.

Banner Specifications and Dimensions: Unley Road

UNLEY ROAD – North and South

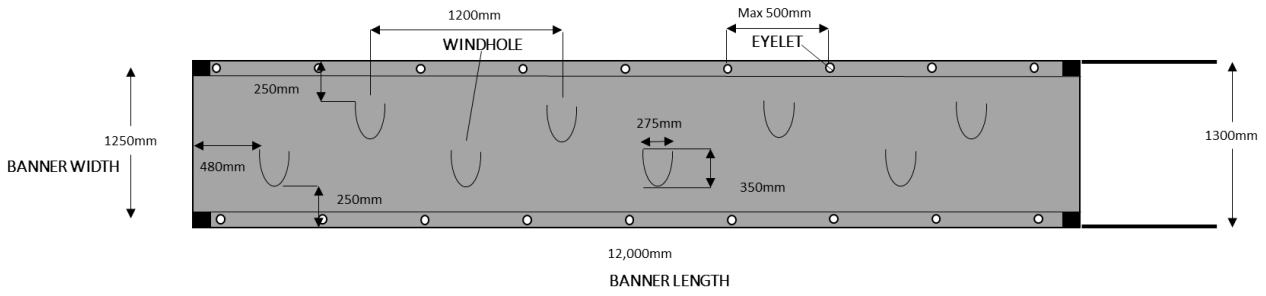

Windholes:

- Two rows at 1200mm spacing. U-shaped 275mm x 350mm.
- Windholes should be 480mm from banner width edge and 250mm from banner length edge

Eyelets:

- 15mm eyelets. Space between edge of banner and eyelet hole is 25mm.
- Maximum 500mm spacing between each eyelet

Unley Road North (Banner is not centralised between poles)

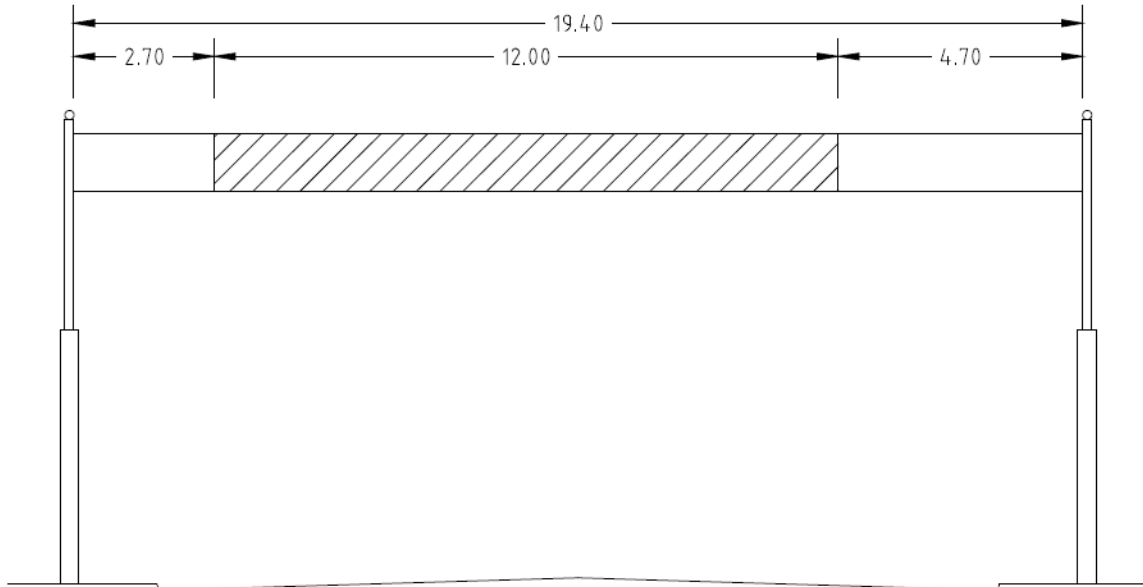

Unley Road South

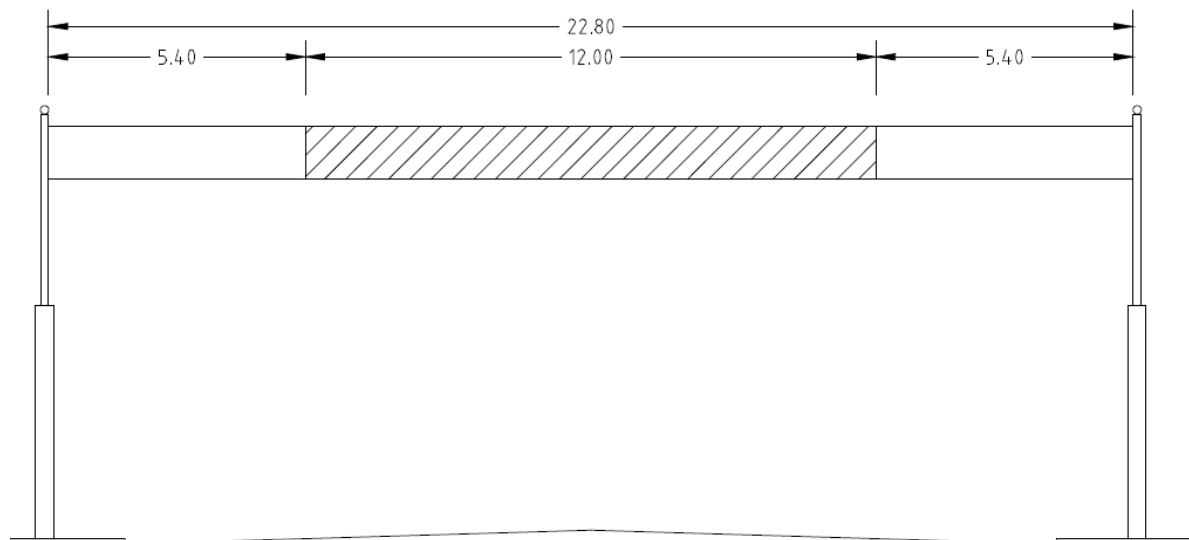

Banner dimensions: King William Road North

Specifications

King William Road– North

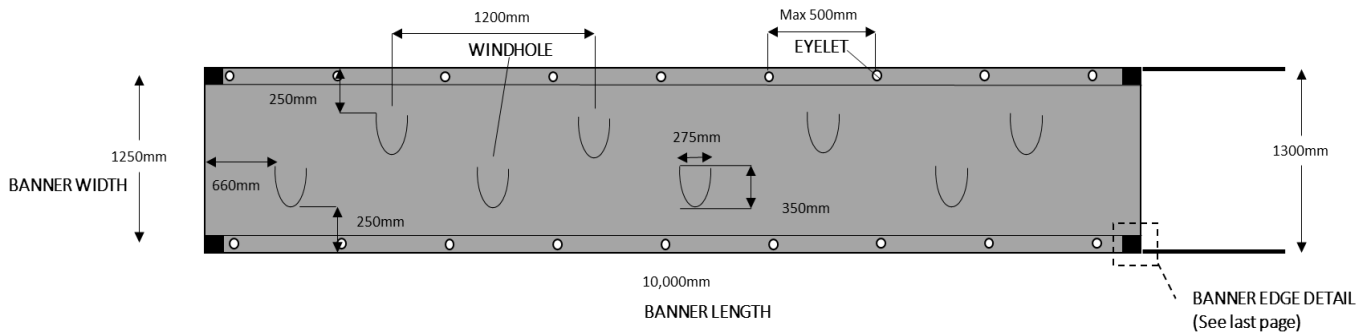

Windholes:

- Two rows at 1200mm spacing, U-shaped 275mm x 350mm.
- Windholes should be 660mm from banner width edge and 250mm from banner length edge

Eyelets:

- 15mm eyelets. Space between edge of banner and eyelet hole is 25mm.
- Maximum 500mm spacing between each eyelet

King William Road North

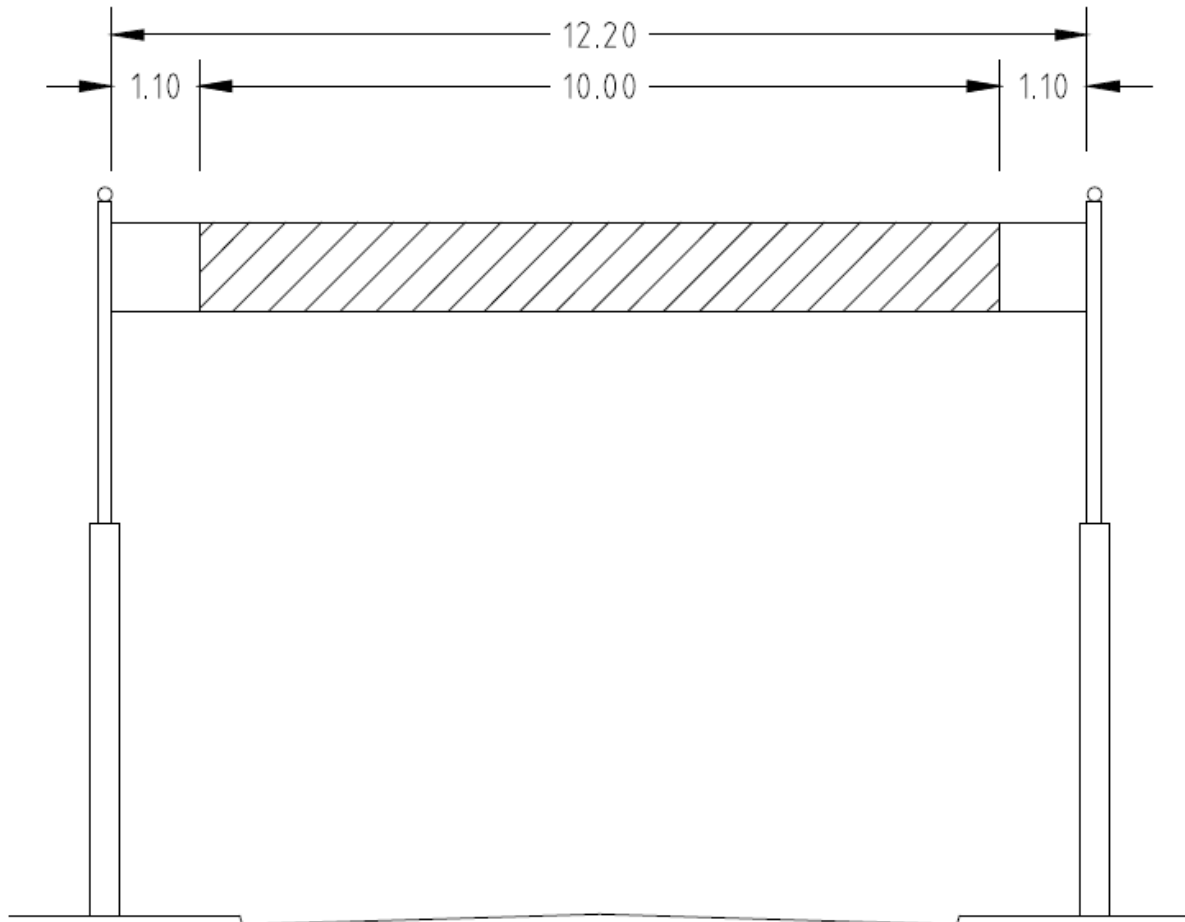

Banner dimensions: King William Road South

Specifications

King William Road– South

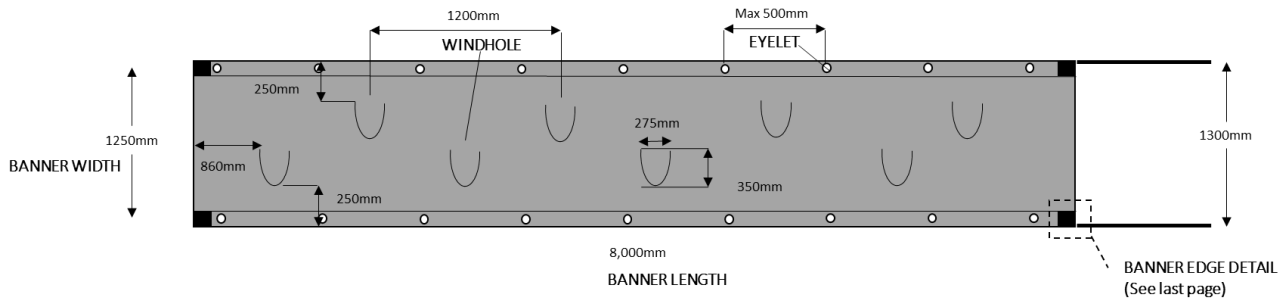

Windholes:

- Two rows at 1200mm spacing. U-shaped 275mm x 350mm.
- Windholes should be 860mm from banner width edge and 250mm from banner length edge

Eyelets:

- 15mm eyelets. Space between edge of banner and eyelet hole is 25mm.
- Maximum 500mm spacing between each eyelet

King William Road South

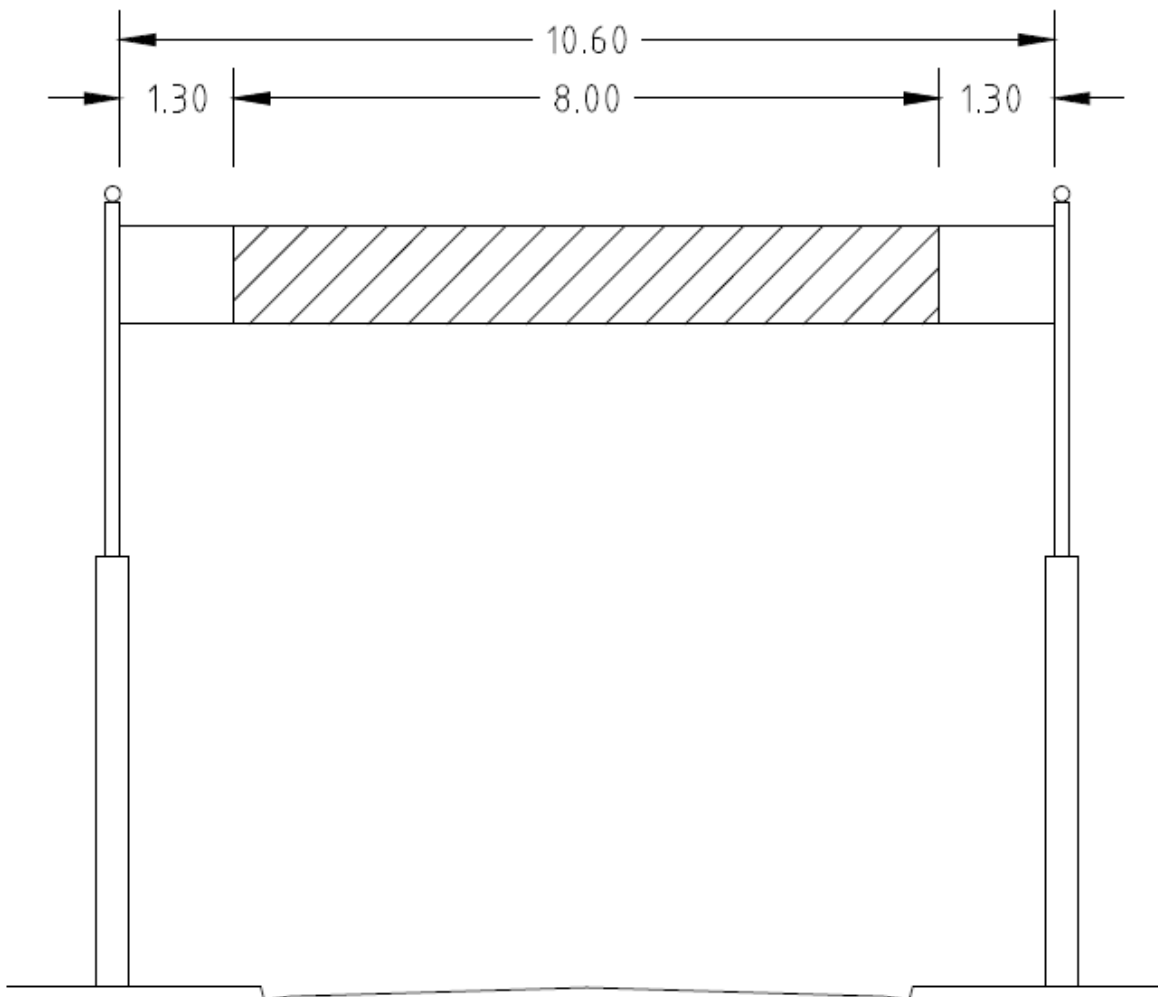

Banner dimensions: Goodwood Road

Specifications

Goodwood Road

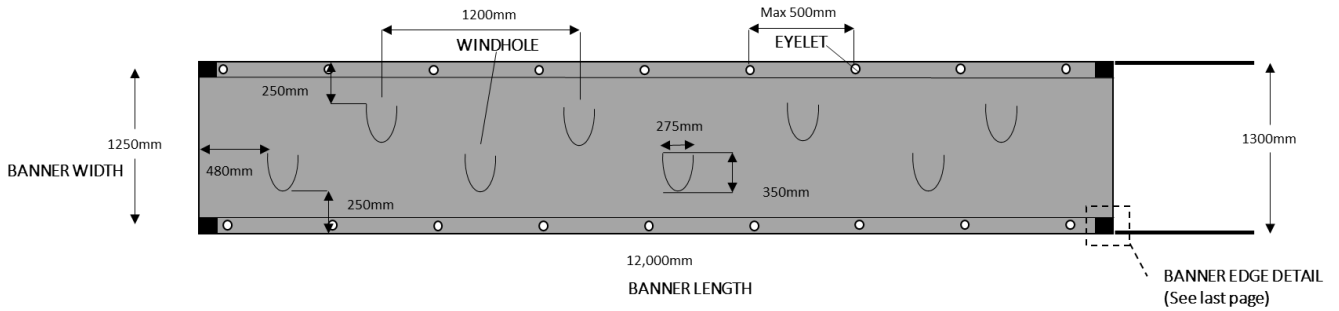

Windholes:

- Two rows at 1200mm spacing. U-shaped 275mm x 350mm.
- Windholes should be 480mm from banner width edge and 250mm from banner length edge

Eyelets:

- 15mm eyelets. Space between edge of banner and eyelet hole is 25mm.
- Maximum 500mm spacing between each eyelet

Goodwood Road North

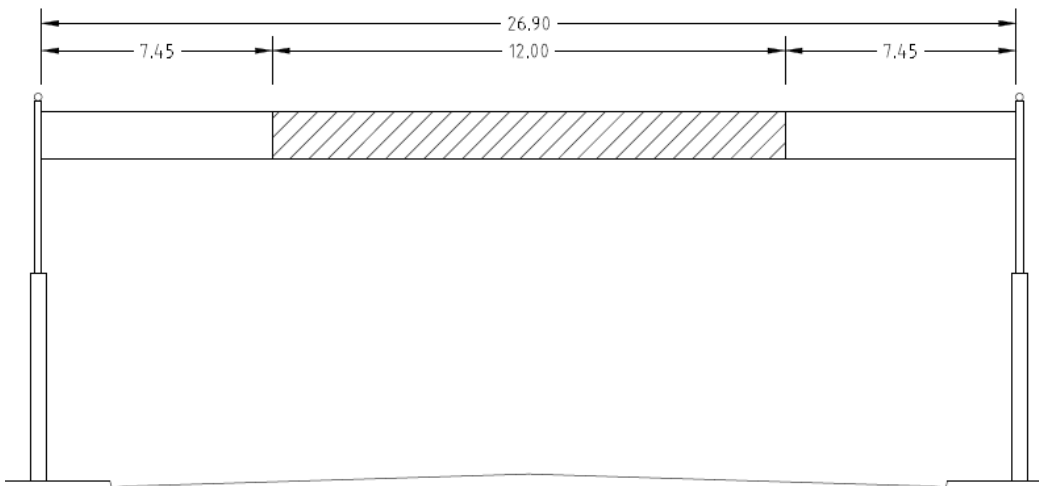

Goodwood Road South

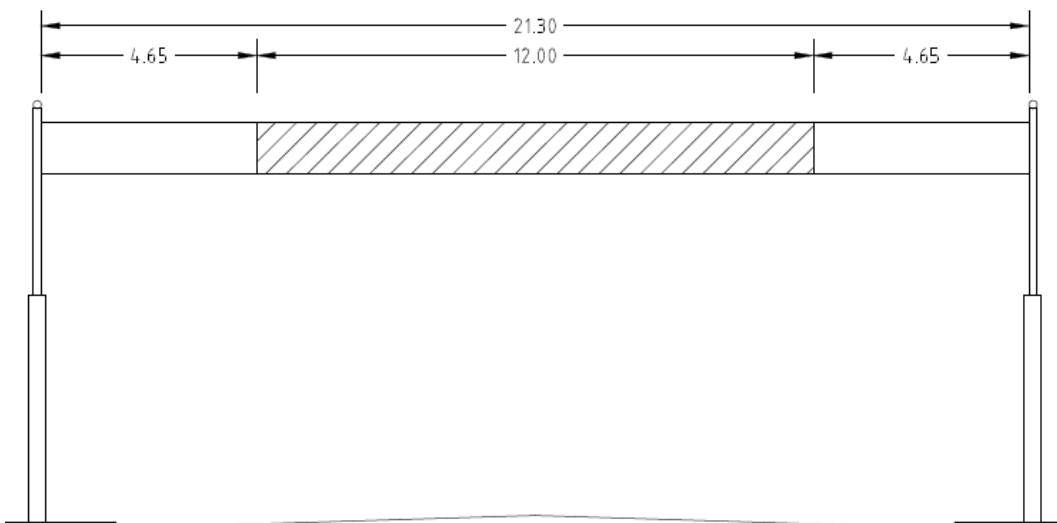

Banner edge detail: All sites

